



# TALL GLASS OF WATER PROJECT

BERTIE COUNTY, NORTH CAROLINA

VINES ARCHITECTURE

# PROPOSED TEAM

## VINES ARCHITECTURE Architecture



**VICTOR VINES** AIA, LEED AP  
Principal-in-Charge /  
Managing Principal



**JOLIE THOMAS** AIA  
Design Principal



**DAVE HARDIN**  
Project Manager



**JEFF SCHROEDER** AIA, LEED AP  
Project Architect



**WILL CHOI** AIA  
Project Designer

## DESIGNWORKSHOP Landscape Architecture



**KURT CULBERTSON**  
PHD, FASLA, FAICP, LEED AP  
Principal-in-Charge



**EMILY McCOY** PLA, ASLA, SITES AP  
Project Manager



**ADELINE LERNER** SITES AP LEED  
Landscape Designer



**LINDSEY NAYLOR** ASSOC. ASLA  
Landscape Designer

## CAPE FEAR ENGINEERING Civil Engineering



**MATT HALEY** PE, LEED GREEN ASSOC.  
Project Manager





**VINES ARCHITECTURE**  
Raleigh, NC

**'TALL GLASS OF WATER' SITE**  
Bertie County, NC [2 hours by car]

- 1 Roanoke Rapids, NC**  
Roanoke Canal Museum and Trail
- 2 Enfield, NC**  
Combined Enfield Middle and Inborden Elementary Schools
- 3 Rocky Mount, NC**  
Rocky Mount Event Center
- 4 Plymouth, NC**  
Roanoke River Lighthouse and Maritime Museum
- 5 Elizabeth City, NC**  
Ridley Student Center Addition and Renovation  
Campus Master Plan  
School of Pharmacy
- 6 Columbia, NC**  
Walter B. Jones Center for the Sounds
- 7 Greenville, NC**  
New Student Center [Initial Planning]
- 8 Fayetteville, NC**  
NC Civil War & Reconstruction History Center
- 9 Wilmington, NC**  
Pine Valley Library
- 10 Ahoskie, NC**  
Roanoke Chowan CC Student Activities Center

- VINES' PROJECTS
- VINES' PROJECTS  
[through previous association]

**WE WORK WITHIN THE REGION AND  
THROUGHOUT THE STATE OF NORTH CAROLINA**

# REGIONAL EXPERIENCE

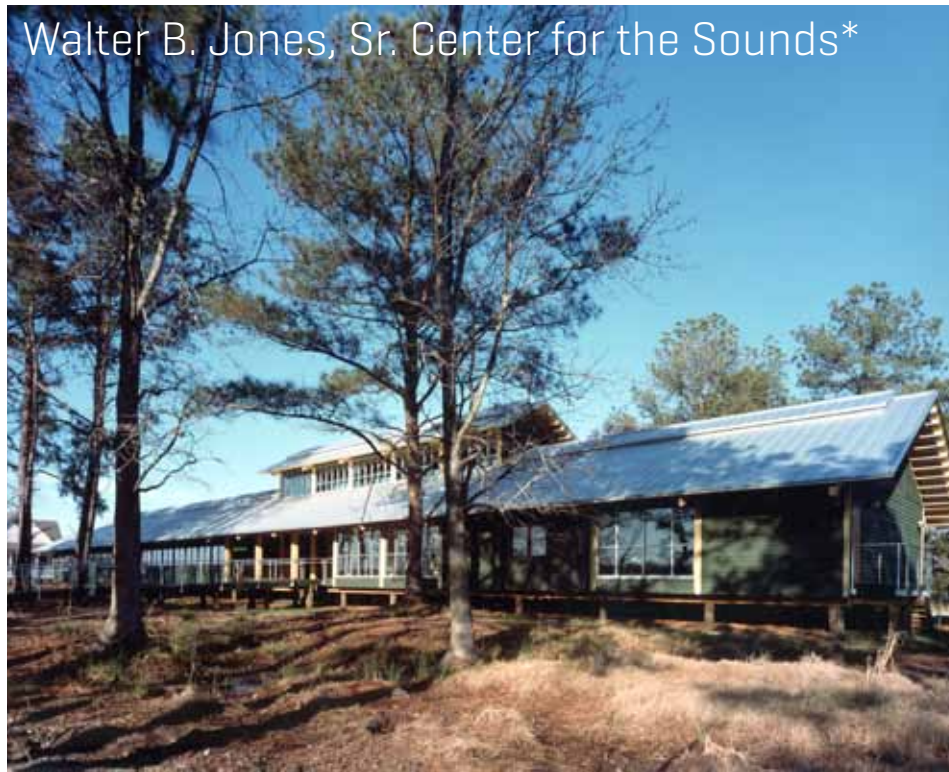
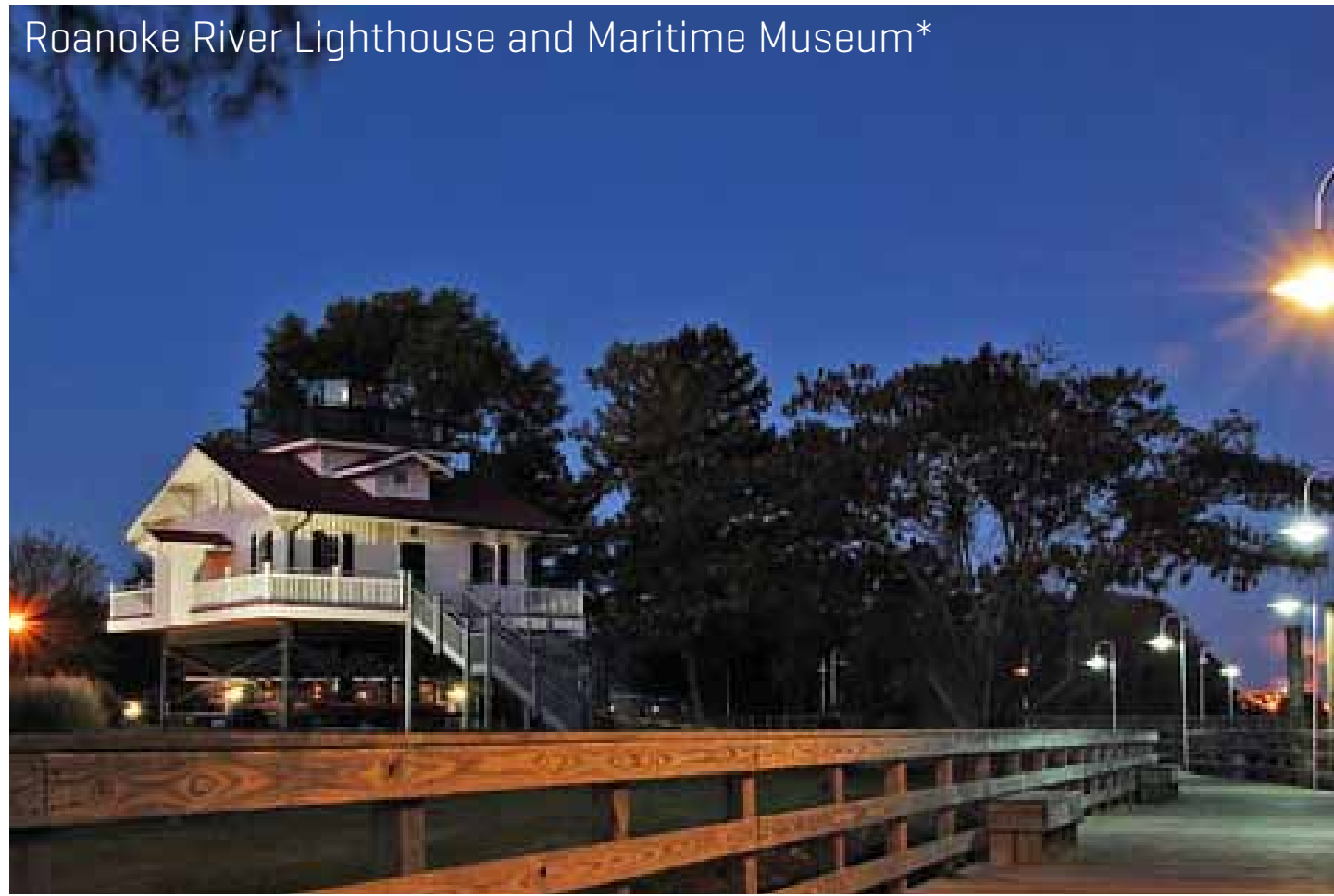
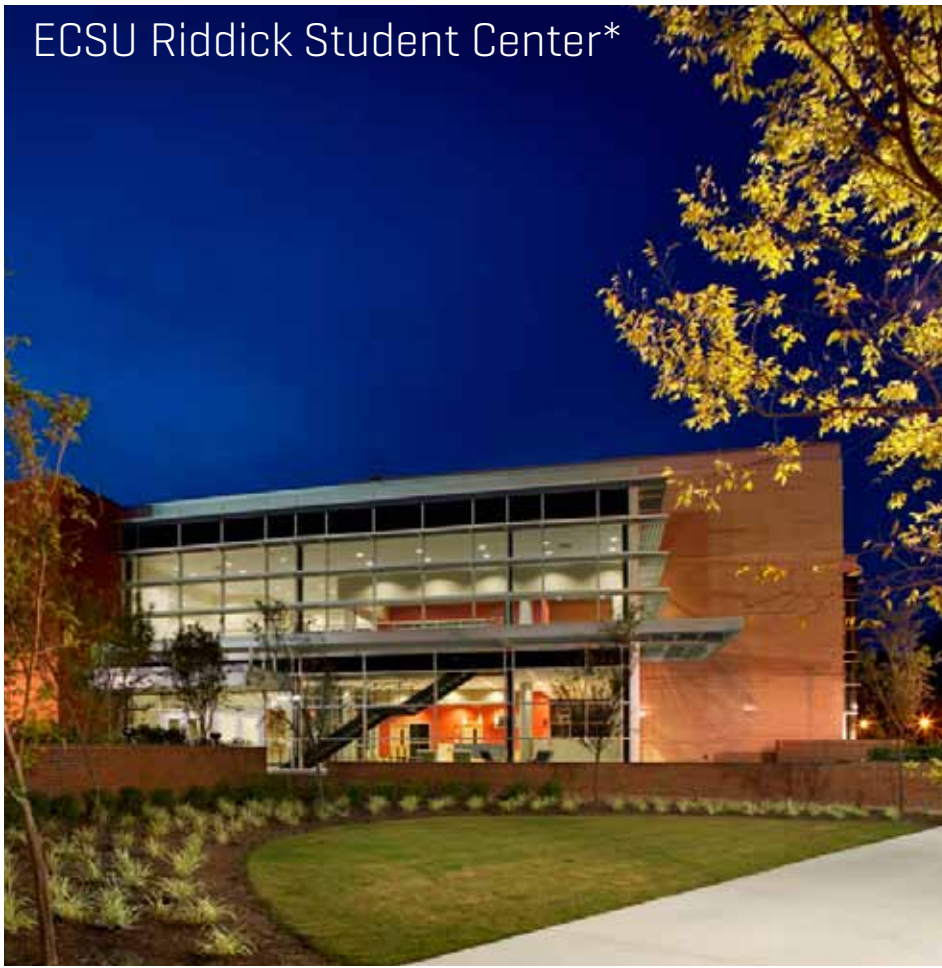

ECSU School of Pharmacy\*

ECSU Riddick Student Center\*

Roanoke River Lighthouse and Maritime Museum\*

Roanoke-Chowan Comm. College Student Activities Center

Roanoke River Lighthouse and Maritime Museum\*

Walter B. Jones, Sr. Center for the Sounds\*

Combined Enfield Middle and Inborden Elementary Schools\*

# VISITOR BASED EXPERIENCE



Durham Main Library

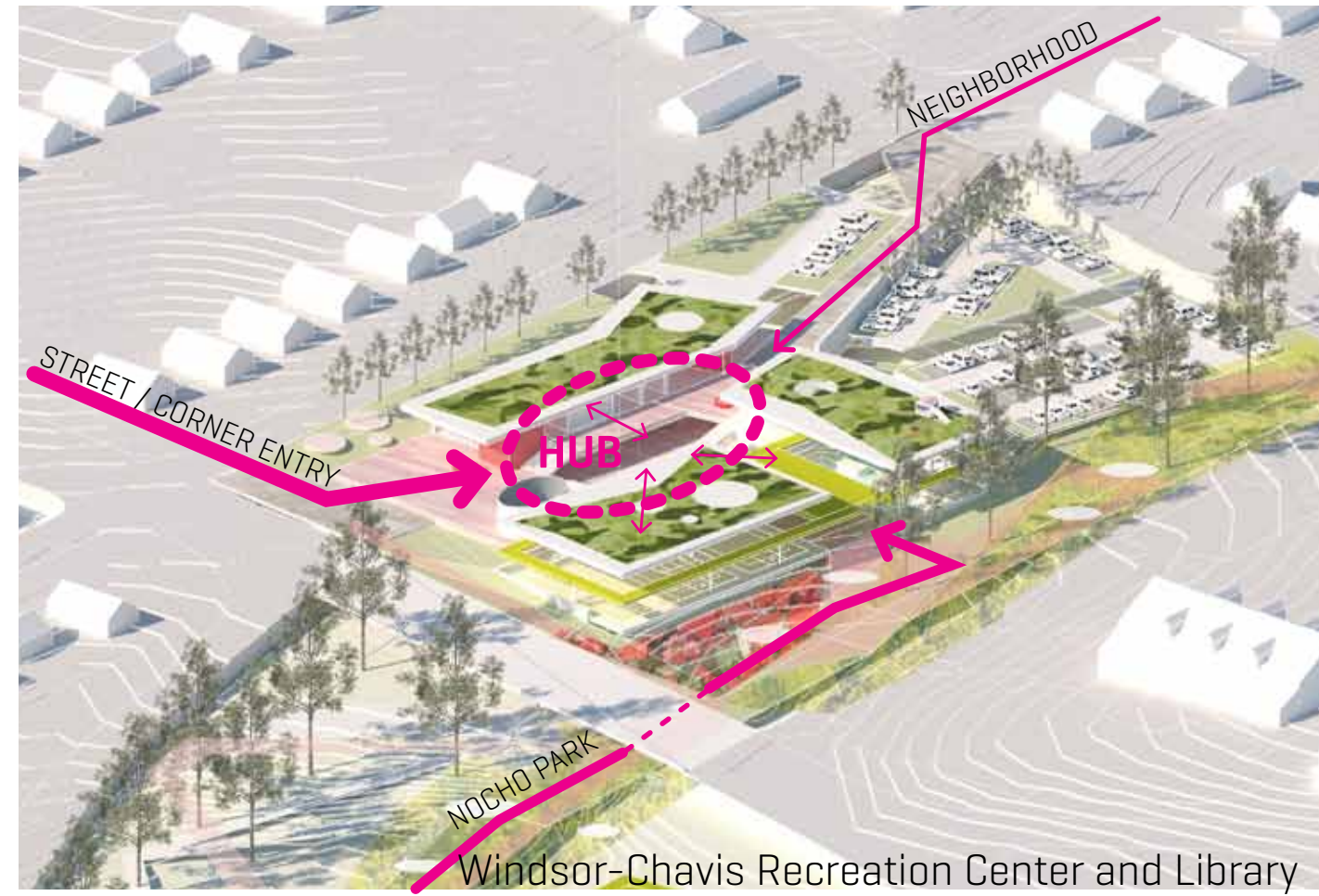

Windsor-Chavis Recreation Center and Library



NC A&T New Student Center



NC Civil War and Reconstruction History Center



Cleveland MLK Library

# WATER + CULTURAL PROJECTS



Lake Johnson Boathouse\*



HL Hunley Museum and Plaza Proposal



Houston Arboretum (Design Workshop)



Pine Valley Library

# ECO / SUSTAINABLE PROJECTS



Ghost 5 Community Pavillion\*



NC Civil War and Reconstruction History Center



Lake Johnson Boathouse\*



Blue Hole Regional Park [Design Workshop]

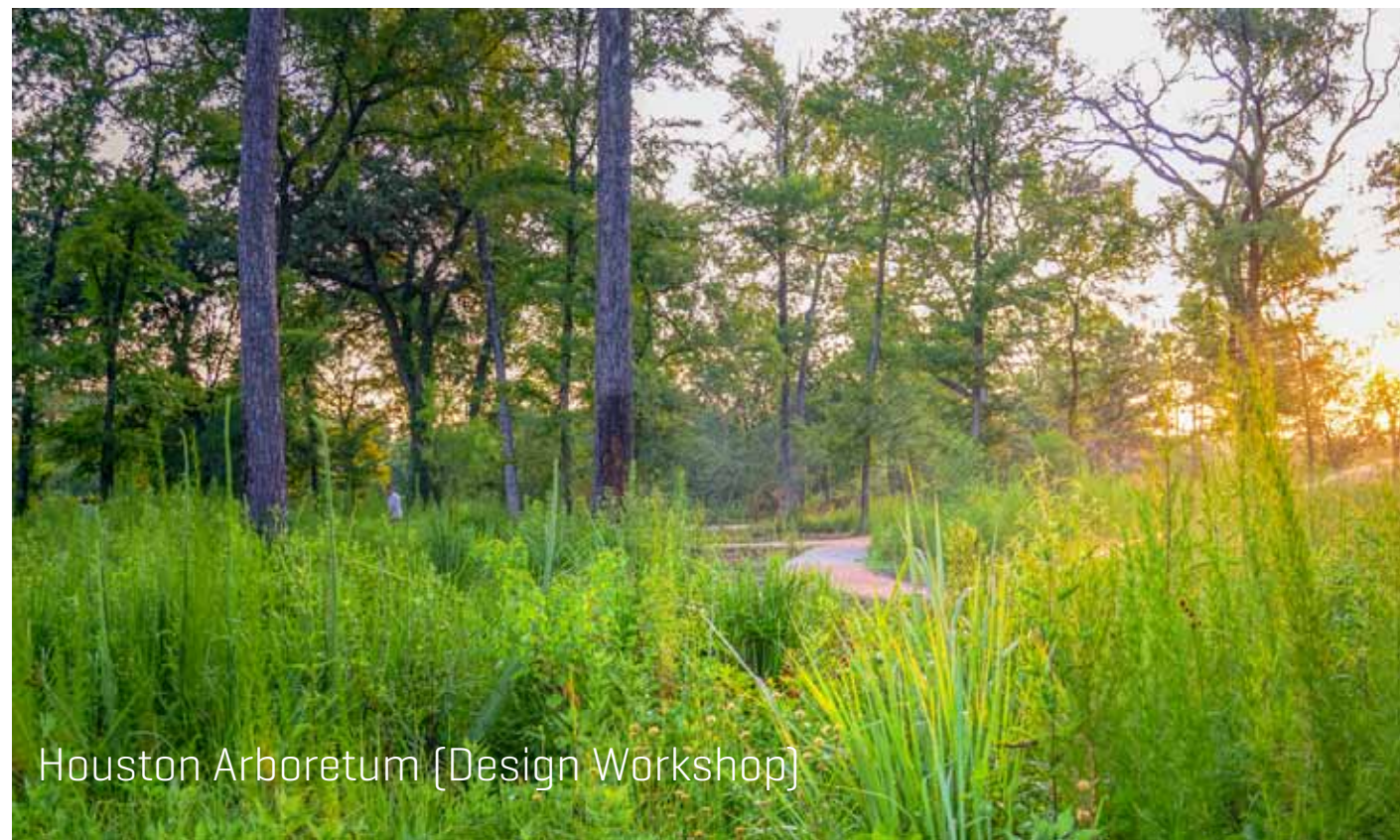

Houston Arboretum [Design Workshop]



Story Mill Park [Design Workshop]

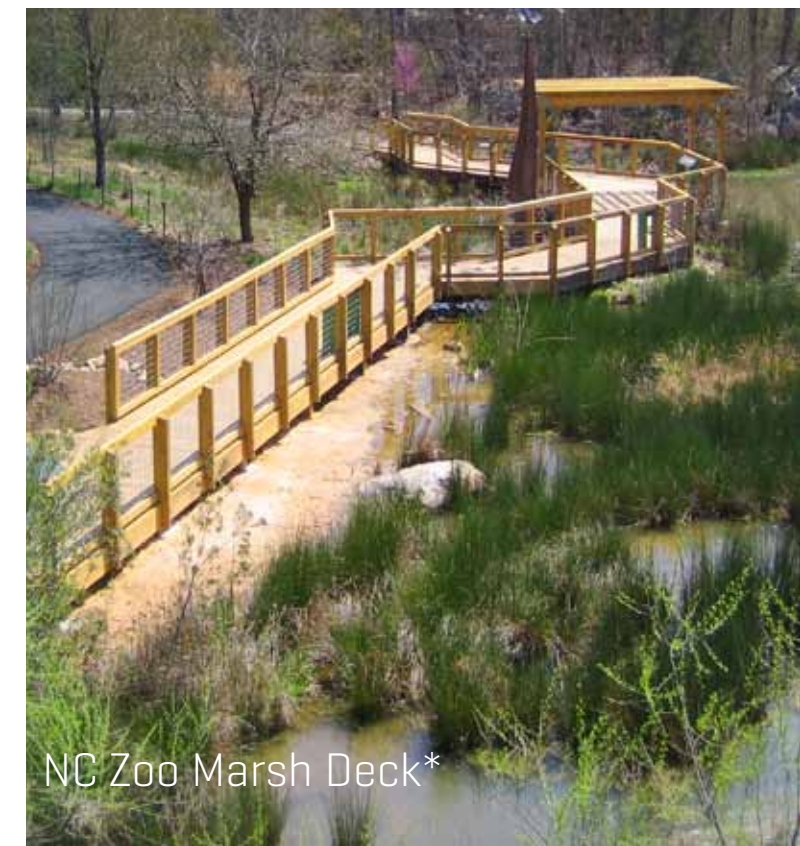

NC Zoo Marsh Deck\*

CASE STUDY



# STORY MILL PARK

BOZEMAN, MONTANA

HONORING CULTURAL HISTORY



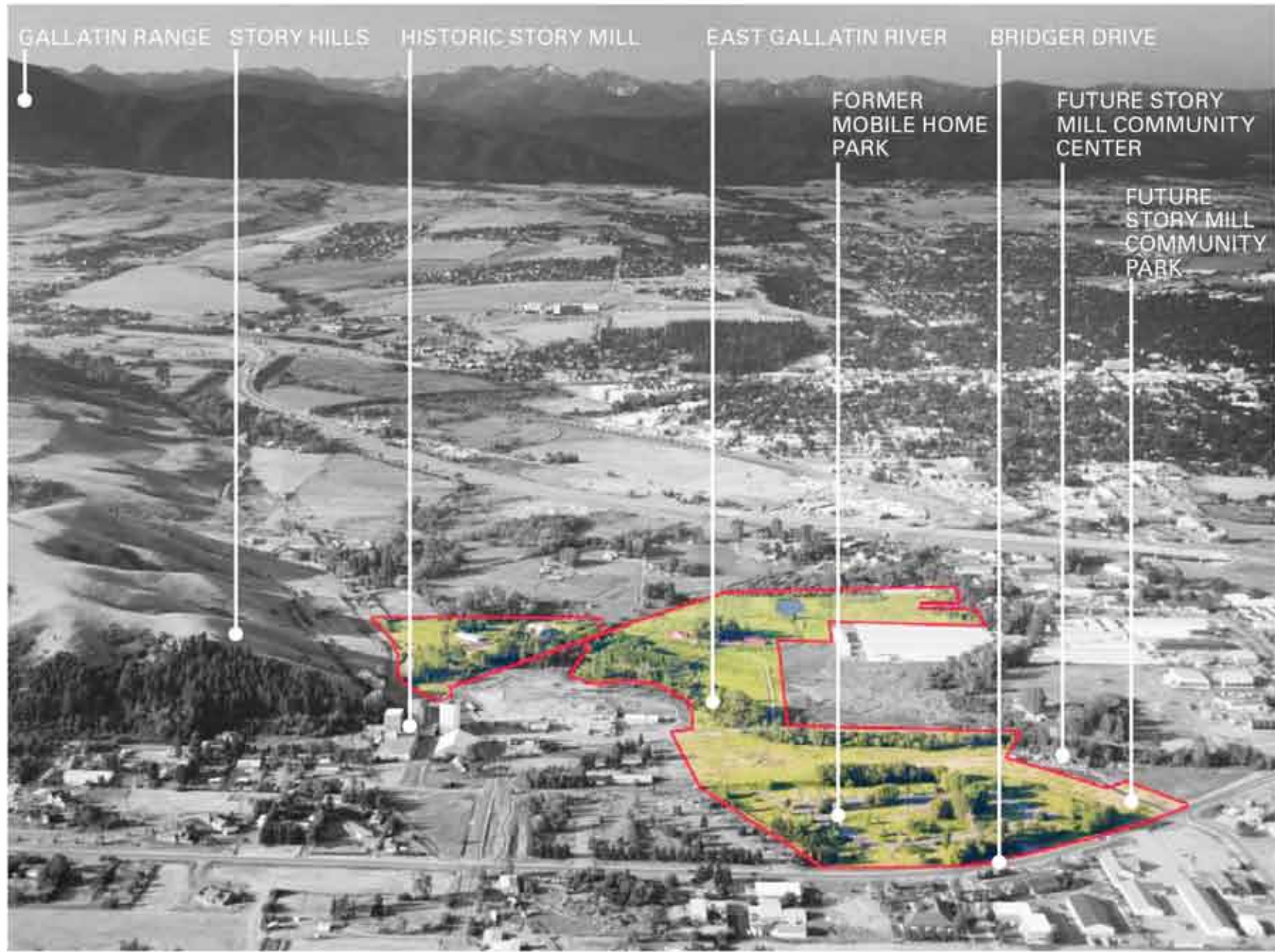



- ① COMMUNITY GATHERING LAWN
- ② PICNIC PAVILION
- ③ MULTIGENERATIONAL PLAY
- ④ FOOD FOREST TRAIL
- ⑤ TEACHING GARDEN
- ⑥ PROMENADE
- ⑦ PROMENADE PAVILION
- ⑧ ACTIVITY LAWN
- ⑨ SPLASH PAD
- ⑩ STORY MILL COMMUNITY CENTER
- ⑪ LABYRINTH
- ⑫ SLEDDING HILL
- ⑬ OBSERVATORY HILL
- ⑭ CLIMBING BOULDER AMPHITHEATER
- ⑮ ACCESSIBLE FISHING PLATFORM
- ⑯ MESSY PLAY AT RIVER ACCESS
- ⑰ STORY MILL
- ⑱ BIRD BLIND WALK
- ⑲ HOMESTEAD PAVILION
- ⑳ FISHING ACCESS
- ㉑ DOG PARK





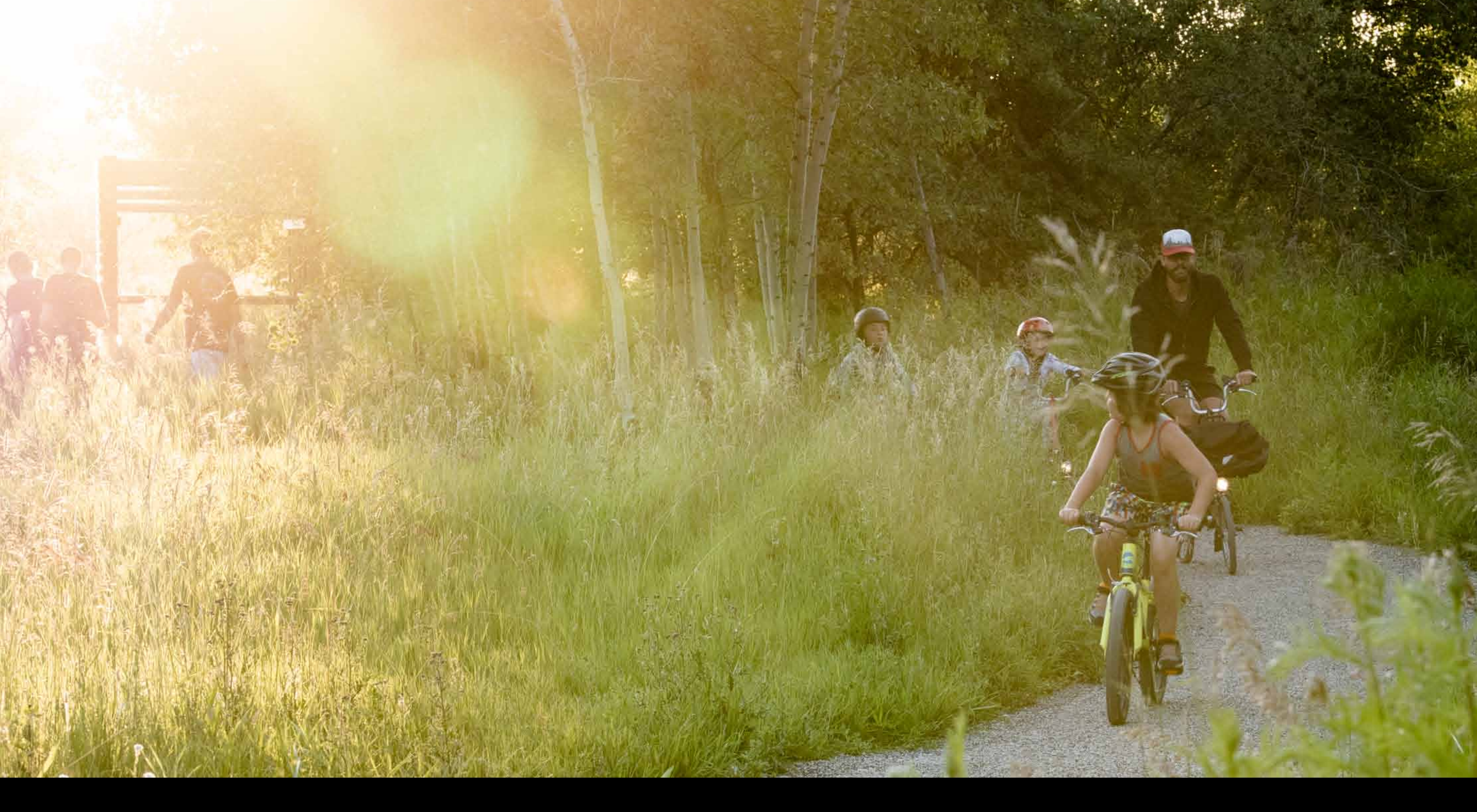

CASE STUDY

# NC CIVIL WAR HISTORY CENTER

HIGHLIGHTING A HISTORIC SITE

# FAYETTEVILLE ARSENAL

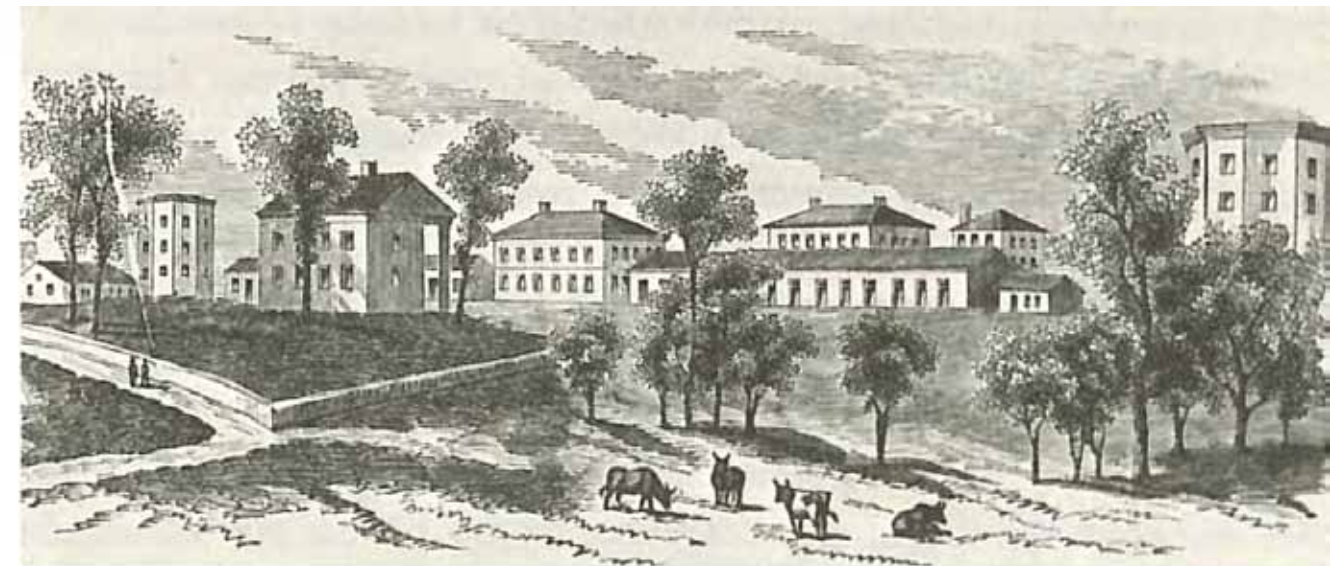
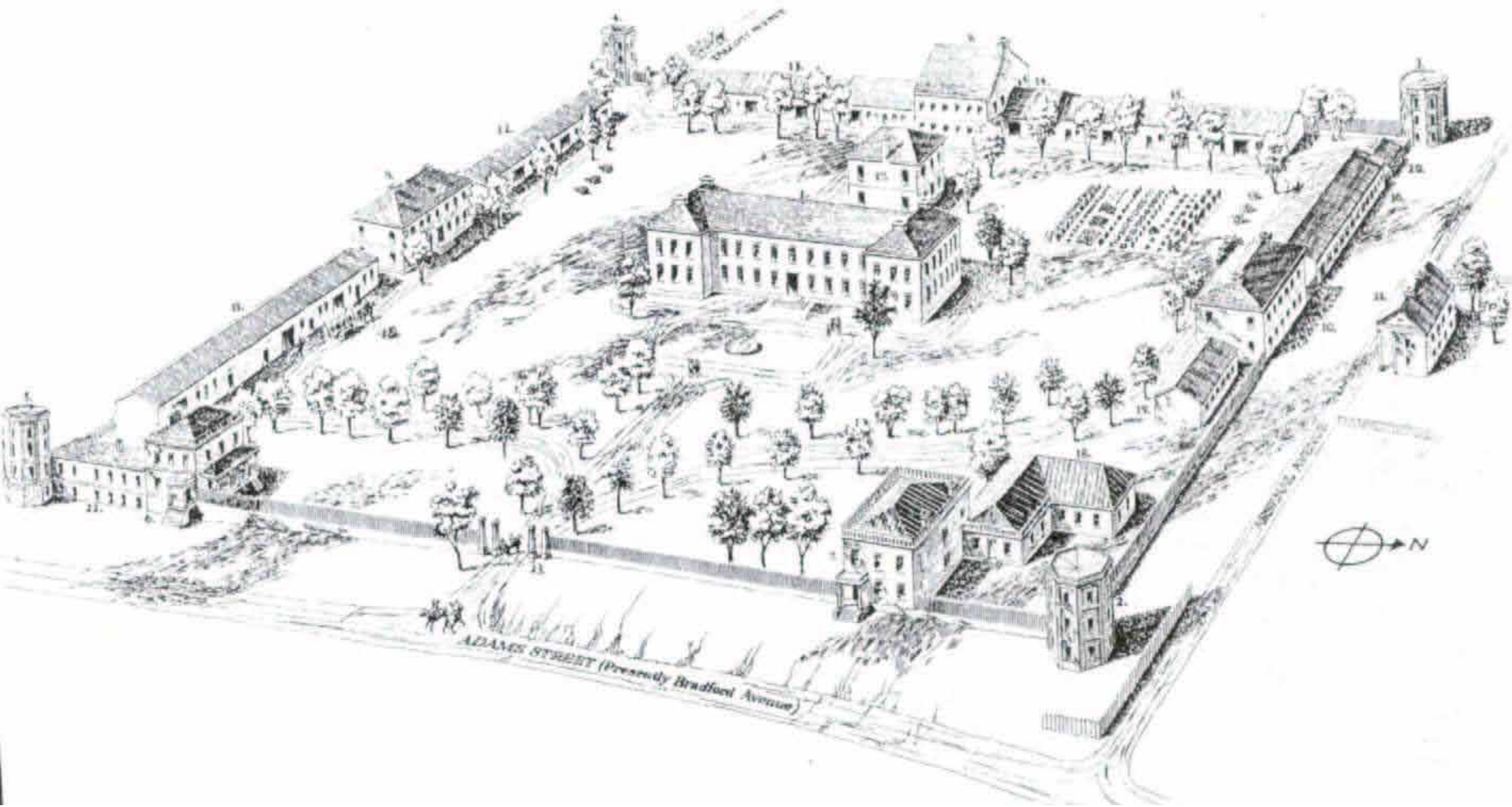

United States Arsenal at Fayetteville. Captured by state troops on April 22, 1861.  
(From Lossing's *Pictorial History of the Civil War*)

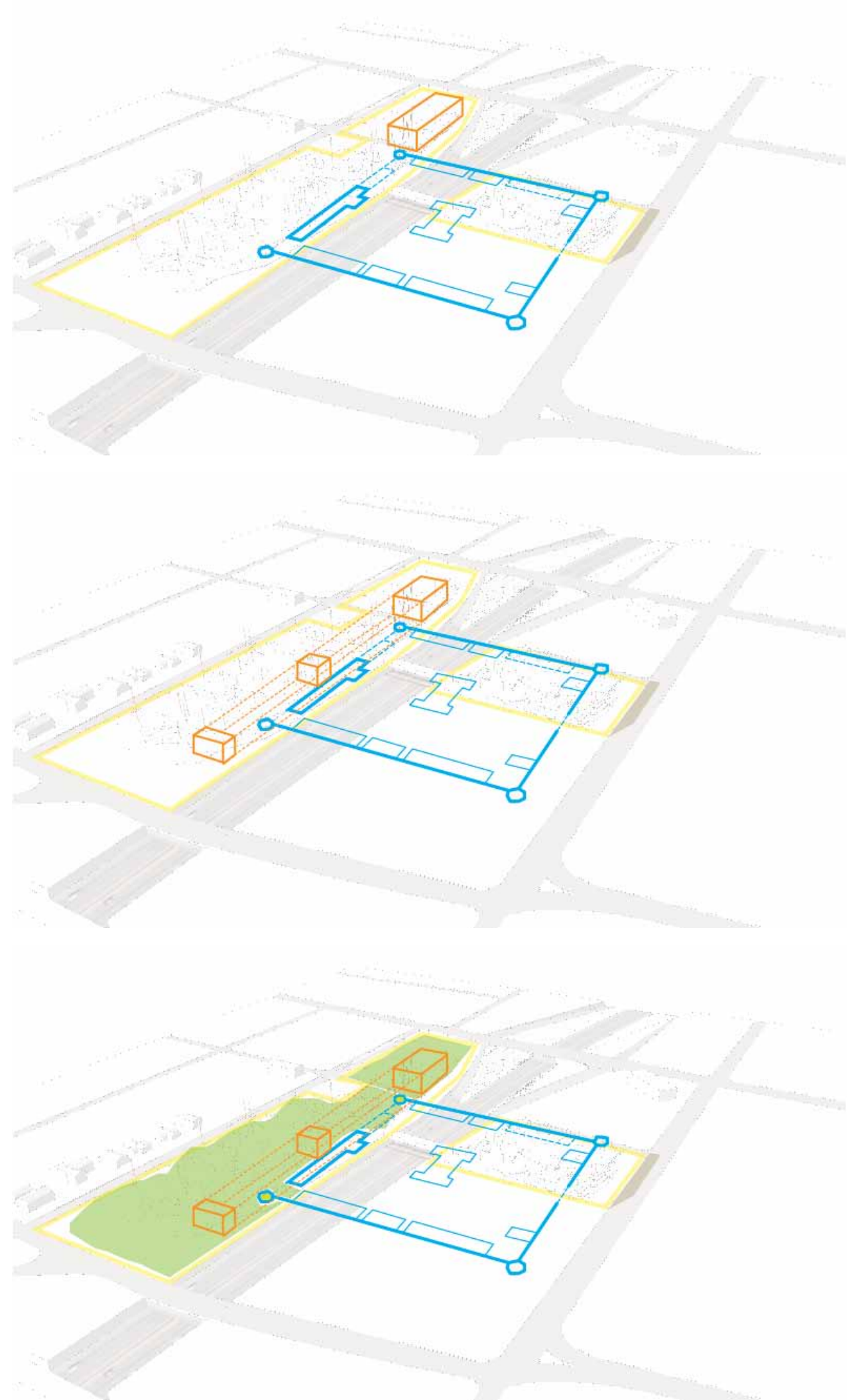
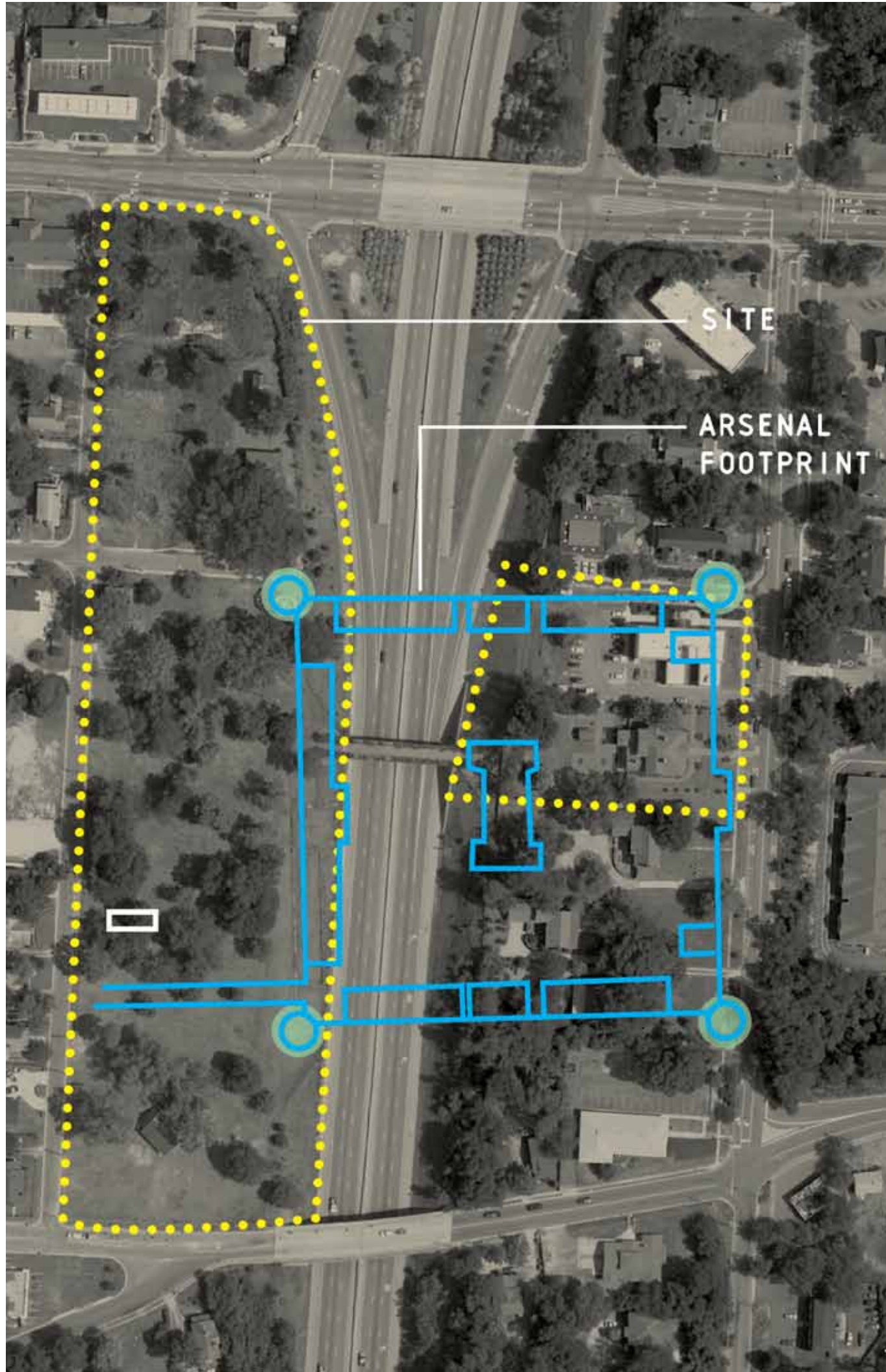



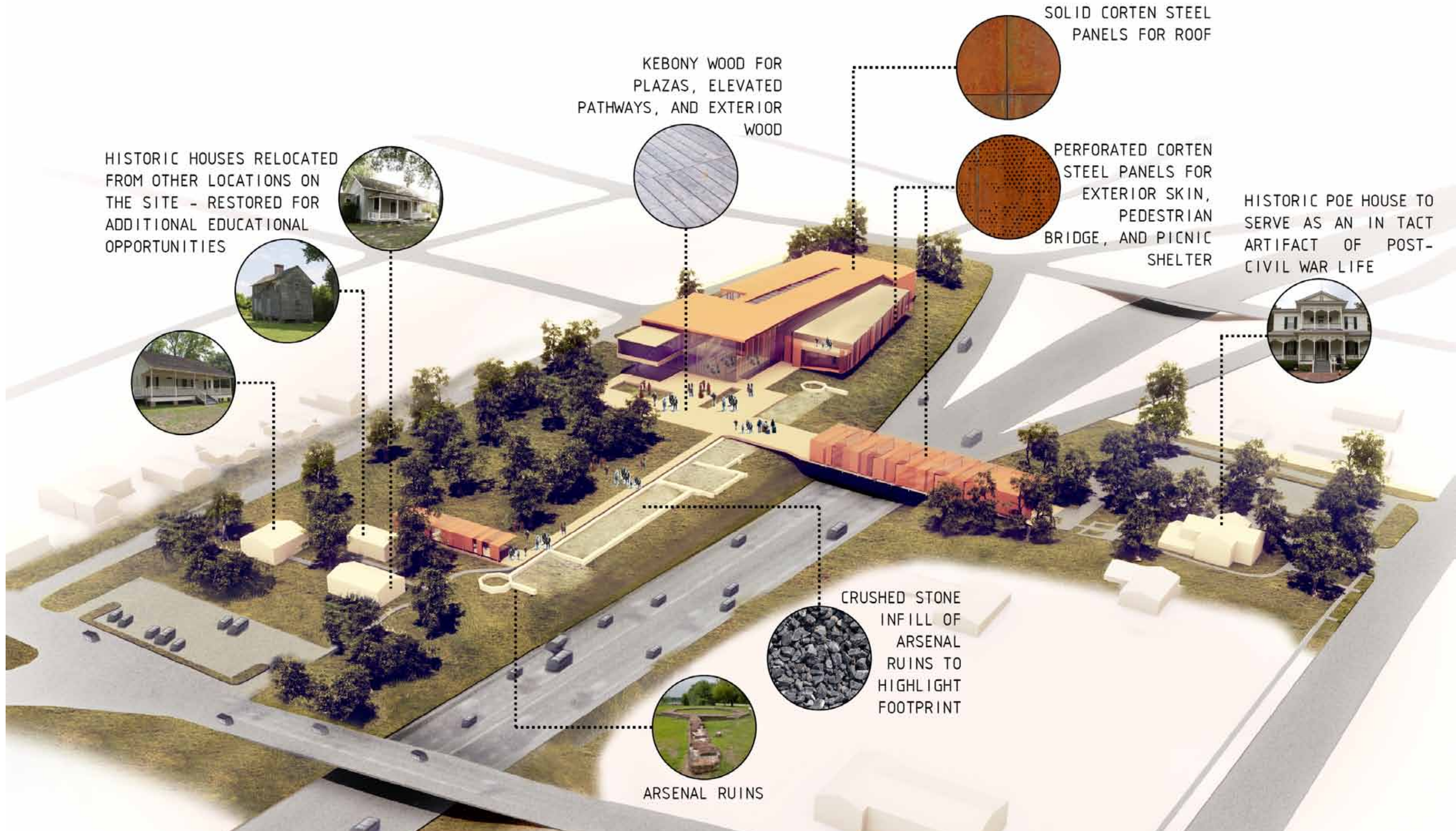

HISTORIC HOUSES RELOCATED FROM OTHER LOCATIONS ON THE SITE - RESTORED FOR ADDITIONAL EDUCATIONAL OPPORTUNITIES



KEBONY WOOD FOR PLAZAS, ELEVATED PATHWAYS, AND EXTERIOR WOOD



SOLID CORTEN STEEL PANELS FOR ROOF

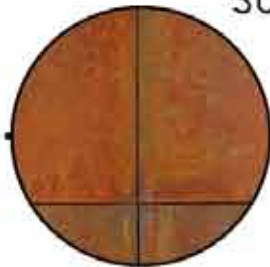

PERFORATED CORTEN STEEL PANELS FOR EXTERIOR SKIN, PEDESTRIAN BRIDGE, AND PICNIC SHELTER

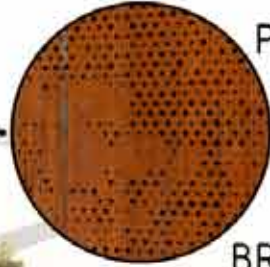

HISTORIC POE HOUSE TO SERVE AS AN IN TACT ARTIFACT OF POST-CIVIL WAR LIFE



CRUSHED STONE INFILL OF ARSENAL RUINS TO HIGHLIGHT FOOTPRINT



ARSENAL RUINS



# STAKEHOLDER ENGAGEMENT

A **PARTICIPATORY** PROCESS THAT IS COMPREHENSIVE, INCLUSIVE, ENGAGING, AND BUILDS CONSENSUS!

PROJECT  
LEADERS

COUNTY +  
RECREATION  
STAFF

ALLIED  
PARTNERS

GOVERNMENT  
AGENCIES

REGIONAL  
'VISITORS'

GENERAL  
PUBLIC



# TGoW INPUT COMMITTEE SESSION

